

ECT 0.3% (0.5%, 1.0%) 8473

Industrial Pressure Transmitter



Features

- Economical
- Good media compatibility
- Relative or absolute pressure measurement
- Titanium version optional
- Frontal membrane optional

Technical Data

Measuring principle	Thick film on ceramic	Accuracy @ 25°C typ.	± 0.3 % FS typ. (± 0.5 % FS typ., ± 1 % FS typ.)
Measuring range	0 ... 0.1 to 0 ... 40 bar 0 ... 1.5 to 0 ... 500 psi	Media temperature	-25°C ... +125°C
Output signal	4 ... 20 mA, 0 ... 5 VDC, 1 ... 6 VDC, 0 ... 10 VDC, 0.5 ... 4.5 VDC ratiom.	Ambient temperature	-25°C ... +85°C

Standard products (extra short lead time)

Product No.	Type Code	Pressure range [bar]	Over pressure max. [bar]	Pressure connection	Signal output	Accuracy @ 25°C typ. [%]
ECT0.1A	8473 66 5417 05 0000 0000 19 58 61	0 ... 0.1	2	G1/4" male	4 ... 20 mA	1.0
ECT0.2A	8473 68 5417 05 0000 0000 19 58 61	0 ... 0.2	2	G1/4" male	4 ... 20 mA	0.5
ECT0.4A	8473 69 5417 05 0000 0000 19 58 61	0 ... 0.4	2	G1/4" male	4 ... 20 mA	0.5
ECT0.6A	8473 70 5417 05 0000 0000 19 58 61	0 ... 0.6	2	G1/4" male	4 ... 20 mA	0.3
ECT0.1V	8473 66 5417 05 0000 0000 17 58 61	0 ... 0.1	2	G1/4" male	0 ... 10 VDC	1.0
ECT0.2V	8473 68 5417 05 0000 0000 17 58 61	0 ... 0.2	2	G1/4" male	0 ... 10 VDC	0.5
ECT0.4V	8473 69 5417 05 0000 0000 17 58 61	0 ... 0.4	2	G1/4" male	0 ... 10 VDC	0.5
ECT0.6V	8473 70 5417 05 0000 0000 17 58 61	0 ... 0.6	2	G1/4" male	0 ... 10 VDC	0.3
ECTF0.1A	8473 66 5652 05 0000 0000 19 58 61	0 ... 0.1	2	G3/4" frontal membrane	4 ... 20 mA	1.0
ECTF0.2A	8473 68 5652 05 0000 0000 19 58 61	0 ... 0.2	2	G3/4" frontal membrane	4 ... 20 mA	0.5
ECTF0.4A	8473 69 5652 05 0000 0000 19 58 61	0 ... 0.4	2	G3/4" frontal membrane	4 ... 20 mA	0.5
ECTF0.6A	8473 70 5652 05 0000 0000 19 58 61	0 ... 0.6	2	G3/4" frontal membrane	4 ... 20 mA	0.3
ECTF1.0A	8473 71 5652 05 0000 0000 19 58 61	0 ... 1	2	G3/4" frontal membrane	4 ... 20 mA	0.3
ECTF1.6A	8473 73 5652 05 0000 0000 19 58 61	0 ... 1.6	3.2	G3/4" frontal membrane	4 ... 20 mA	0.3
ECTF2.5A	8473 75 5652 05 0000 0000 19 58 61	0 ... 2.5	5	G3/4" frontal membrane	4 ... 20 mA	0.3
ECTF4.0A	8473 76 5652 05 0000 0000 19 58 61	0 ... 4	8	G3/4" frontal membrane	4 ... 20 mA	0.3
ECTF6.0A	8473 77 5652 05 0000 0000 19 58 61	0 ... 6	12	G3/4" frontal membrane	4 ... 20 mA	0.3
ECTF10.0A	8473 78 5652 05 0000 0000 19 58 61	0 ... 10	20	G3/4" frontal membrane	4 ... 20 mA	0.3
ECTF25.0A	8473 80 5652 05 0000 0000 19 58 61	0 ... 25	50	G3/4" frontal membrane	4 ... 20 mA	0.3
ECTF40.0A	8473 81 5652 05 0000 0000 19 58 61	0 ... 40	80	G3/4" frontal membrane	4 ... 20 mA	0.3

Ordering information/type code

Measuring range ¹⁾	Pressure measurement range [bar]	Over pressure [bar]	Burst pressure [bar]	Type	8473 . XX	XX	XX	XX	XX	XX
	Pressure measurement range [psi]	Over pressure [psi]	Burst pressure [psi]	Type						
	0 ... 0.1	2	3	66	F6					
	0 ... 0.16	2	3	67	F7					
	0 ... 0.2	2	3	68	F8					
	0 ... 0.4	2	3	69	F9					
	0 ... 0.6	2	3	70	G0					
	0 ... 1.0	2	3	71	G1					
	0 ... 1.6	3.2	4.8	73	G3					
	0 ... 2.5	5	7.5	75	G5					
	0 ... 4	8	12	76	G6					
	0 ... 6	12	15	77	G7					
	0 ... 10	20	25	78	G8					
	0 ... 16	32	40	79	G9					
	0 ... 25	50	75	80	H0					
	0 ... 40	80	100	81	H1					
Sensor	Relative pressure, 1.4305									54
	Relative pressure, 1.4404/1.4435 ²⁾									56
	Relative pressure, 1.4462									50
	Relative pressure, Titanium Grade 5									51
	Absolute pressure, 1.4305 ^{2) 3)}									84
	Absolute pressure, 1.4404/1.4435 ^{2) 3)}									86
	Absolute pressure, 1.4462 ³⁾									80
Absolute pressure, Titanium Grade 5 ³⁾									81	
Pressure connection	G1/4" female									10
	G1/4" male									17
	G1/2" male ²⁾									21
	1/4" NPT male ²⁾									30
	G3/4" frontal membrane ^{2) 4)}									52
Electrical connection	Male electrical plug EN 175301-803-A, Mat. PA									05
	Male electrical plug M12x1, 5-pole, Mat. PA									35
	Male electrical plug industrial standard (contact distance 9.4 mm) Mat. PBT									01
	Male electrical plug Packard Metri Pack									51
	Cable IP67, Mat. PVC (cable gland PA6-3) ^{5) 6)}									22
	Cable IP68, max. 3m, medium +10°C...+35°C, Pmax. 1 bar rel./abs.									68
Output	Output	Load resistance	I (supply)	U (supply)						
	4 ... 20 mA	(USupply-9V)/ 20mA		9 ... 30 VDC						19
	0 ... 5 VDC	> 2.5 kΩ	< 10 mA	10 ... 30 VDC						14
	1 ... 6 VDC	> 5.0 kΩ	< 10 mA	10 ... 30 VDC						16
	0 ... 10 VDC	> 5.0 kΩ	< 10 mA	15 ... 30 VDC						17
0.5 ... 4.5 VDC	> 5.0 kΩ	< 10 mA	5 VDC ±0.25 V ratiometric						23	

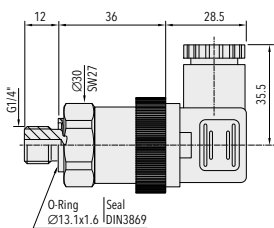

ECT ...

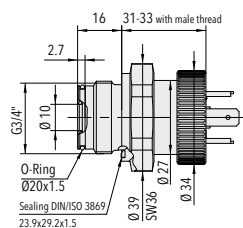

ECTF ...

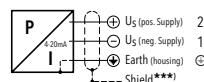

ECT ... A/ECTF ... A (4 ... 20 mA)

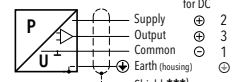

ECT ... V (0 ... 10 V)